

Manufactured by



The Power of Light for Surgery

Lightweight in the hand.

LED light where you need it.

Durable, cordless, and maneuverable.

koplite™

Cordless Lighted Retractor

MADE IN JAPAN

CE
1639

**Cordless.
Lightweight.
Bright.**

The **kopligh™** lighted retractor is cordless (battery-operated) and uses LED light illumination. The resilient, clear plastic blade is nonconductive and easily switched out to suit varying surgical needs. A lightweight, strong, and very bright medical device to help surgeons do their work safely and efficiently.

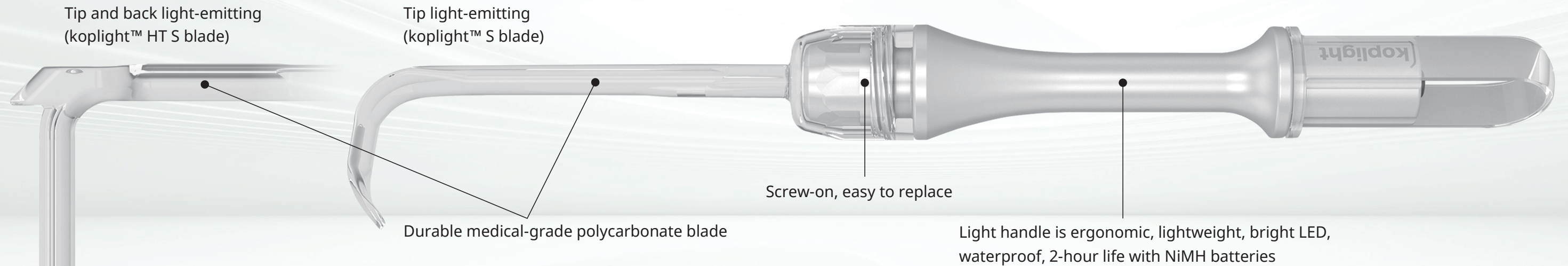

CLEARLY A BETTER CHOICE

Conventional metal retractors

- Surgical light has limited reach
- Metal can hide bodily tissue
- Conductivity can lead to electric scalpel burns
- Obstructs X-ray fluoroscopy and CT-guided operations

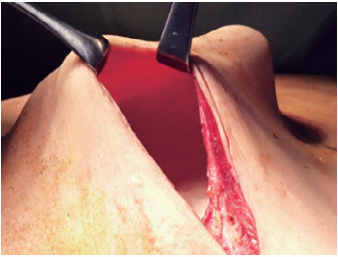

Operate with ease and precision

kopligh™

- **LED light directly illuminates** deep and narrow areas
- Transparent blade keeps tissue visible
- Nonconductive, reduces risk of electric scalpel burns
- Hidden from X-ray fluoroscopy and CT-guided operations

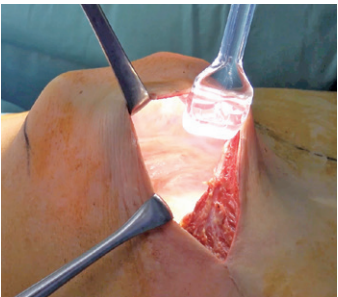

KEY FEATURES & BENEFITS

- Highly durable, safe, clear**
The transparent blade is made of polycarbonate, a material used in bullet-proof glass. This naturally transparent and nonconductive plastic makes the kopligh™ blade virtually unbreakable under normal operating conditions. It also aids clear visibility.
- Light for the operative field**
The kopligh™ light handle can be loaded with large-capacity NiMH batteries to maximize its usage time. Together with its sleek optical design, kopligh™ dependably and brightly illuminates the operative field.
- Cordless, lightweight, maneuverable**
kopligh™ only weighs 100–150 g. Battery-powered, cordless, and with a light aluminum handle, it's easy for surgeons to continually grasp, maneuver, and reposition.

Battery inserter
The battery inserter allows batteries to be loaded into the light handle without contaminating the exterior.



BLADE VARIATIONS

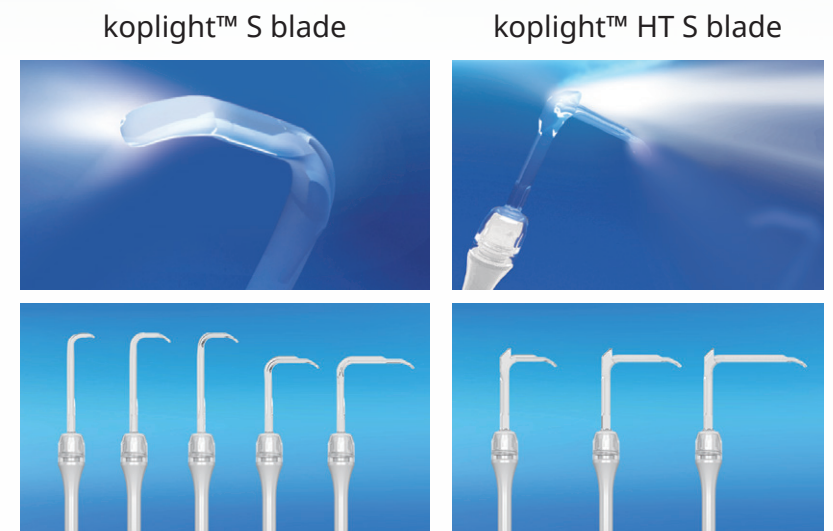

KS-1S	KS-2S	KS-3S	KS-4S	KS-5S	Model Code	KS-4HS	KS-5HS	KS-6HS
10	13	18	18	25	Tip width	18	25	25
30	45	45	59	84	Blade length	61	86	111
139	139	139	113	113	Total length	122	122	122

(mm)



MADE IN JAPAN

Blade models

Product name	Model code	Dimensions (mm)		
		Tip width	Blade length	Total length
koplight™ S blade	KS-1S	10	30	139
	KS-2S	13	45	139
	KS-3S	18	45	139
	KS-4S	18	59	113
	KS-5S	25	84	113
koplight™ HT S blade	KS-4HS	18	61	122
	KS-5HS	25	86	122
	KS-6HS	25	111	122

- Blades are sterilized single-use.
- Blades are available in 12 piece packaging.

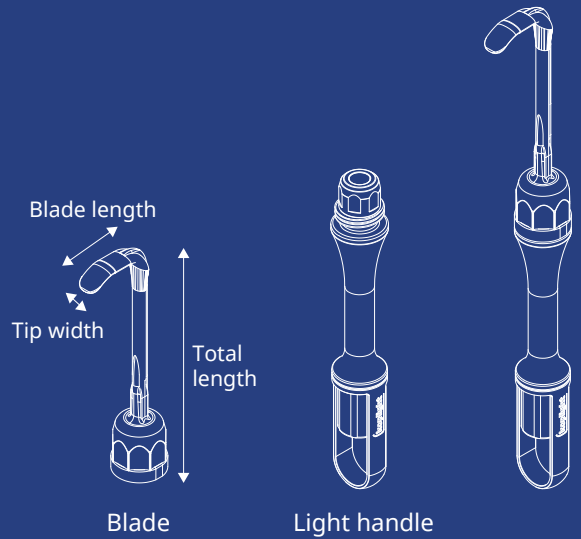

Light handle

Product name	Model code	Retail box contents
koplight™ light handle set	KG-1-SET	1 × light handle, 1 × finger hook, 1 × battery inserter

- The light handle is non-sterile and reusable. Cleaning and sterilization are needed before each use.
- Waterproof rating: IPX-7 (1 m water depth for 30 min. The tail cap should be firmly tightened)
- Battery life: 2 hours with high-end NiMH rechargeable batteries (2 × AAA, actual capacity of ≥900 mAh)

Note: Batteries are not included in the package. To be purchased separately.

EC REP

MT Promedt Consulting GmbH
 Ernst-Heckel-Strasse 7
 66386 St. Ingbert, Germany
 Tel: +49 6894 581020
 www.mt-procons.com

Manufacturer

Yasui Co., Ltd.
 2725 Oazakakusa, Kadogawa-cho,
 Higashiusuki-gun, Miyazaki 889-0697, Japan
 Tel: +81-982-63-7111
<https://yasuico.com>
info@yasuico.com

Since 1930

ISO 13485

SUSTAINABLE DEVELOPMENT GOALS

Yasui Co., Ltd. was founded in 1930 in Osaka as a printing company. We later broadened into areas including injection molding (mainly medical device parts) and medical products (original and OEM).

We are ISO 9001 and ISO 13485 certified, reinforcing quality control and management to meet high international standards.

We applied 90+ years of innovation and quality control in Japanese manufacturing to develop **koplight™**, an original design that meets specific clinical needs. Yasui Medical is aggressively expanding its global reach, bringing Made in Japan quality to the world's markets.